



The Canalside Room

Suggested room layouts & rates

Room Rates

ROOM HIRE

Half day	£55
Full Day	£85

TO INCLUDE:

- Mineral water, cordials and mints
- Use of overhead projector, screen and speakers
- Wireless broadband

EXTRAS / LUNCH:

Tea, coffee and biscuits
£1.95 per delegate

Selection of sandwiches
£5.95 per delegate

Selection of sandwiches with fries
£6.95 per delegate

Or you can order from our regular menu.

Should you have any additional requirements we are happy to discuss these with you.

Room plan & suggested table layouts

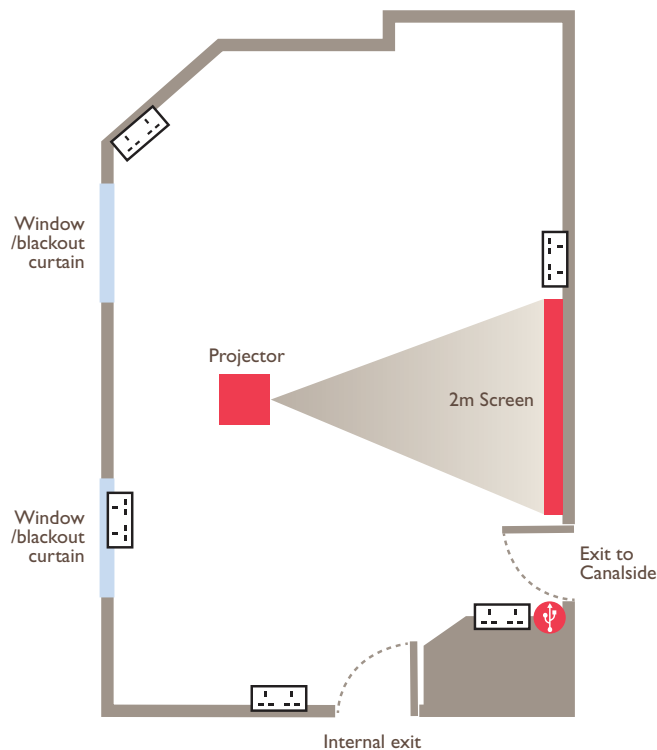

 13 amp double socket

 USB port

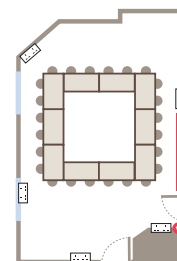

Hollow square
Seats 24

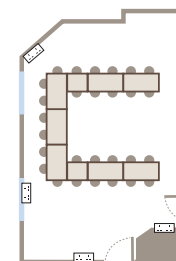

Horseshoe
Seats 18 - 24

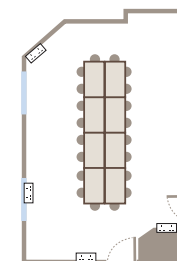

Boardroom
Seats 20

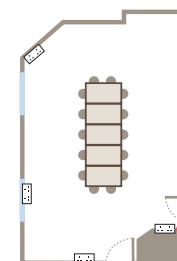

Meeting/Dining
Seats 10 - 16

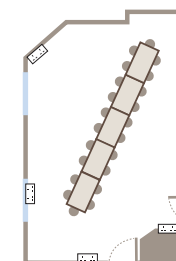

Large dining
Seats up to 24

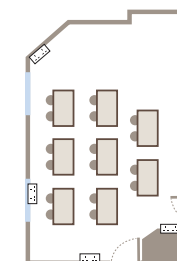

Classroom
Seats 16 - 20

Dell Projector

CONNECTION PANEL:

2 15-pin VGA inputs, S-Video, Composite, one VGA-output/monitor passthrough, one USB port, RS-232C for computer control, one 1/8" audio in, one 1/8" audio out, and a Kensington lock.

VIDEO COMPATIBILITY:

HDTV 1080i, 720p, 576p, 576i, 480p. NTSC/PAL/SECAM.